

Customer Care Solutions NPL-2 Series Cellular Phones

2 - Parts List & Layouts

Table of Contents

	Page No
Exploded view of Nokia NPL-2, 6100	3
Assembly Parts List	4
Parts List Module ----- for NPL-2	5
Component layout diagram Top	20
Component layout diagram Bottom	21

Exploded view of Nokia NPL-2, 6100

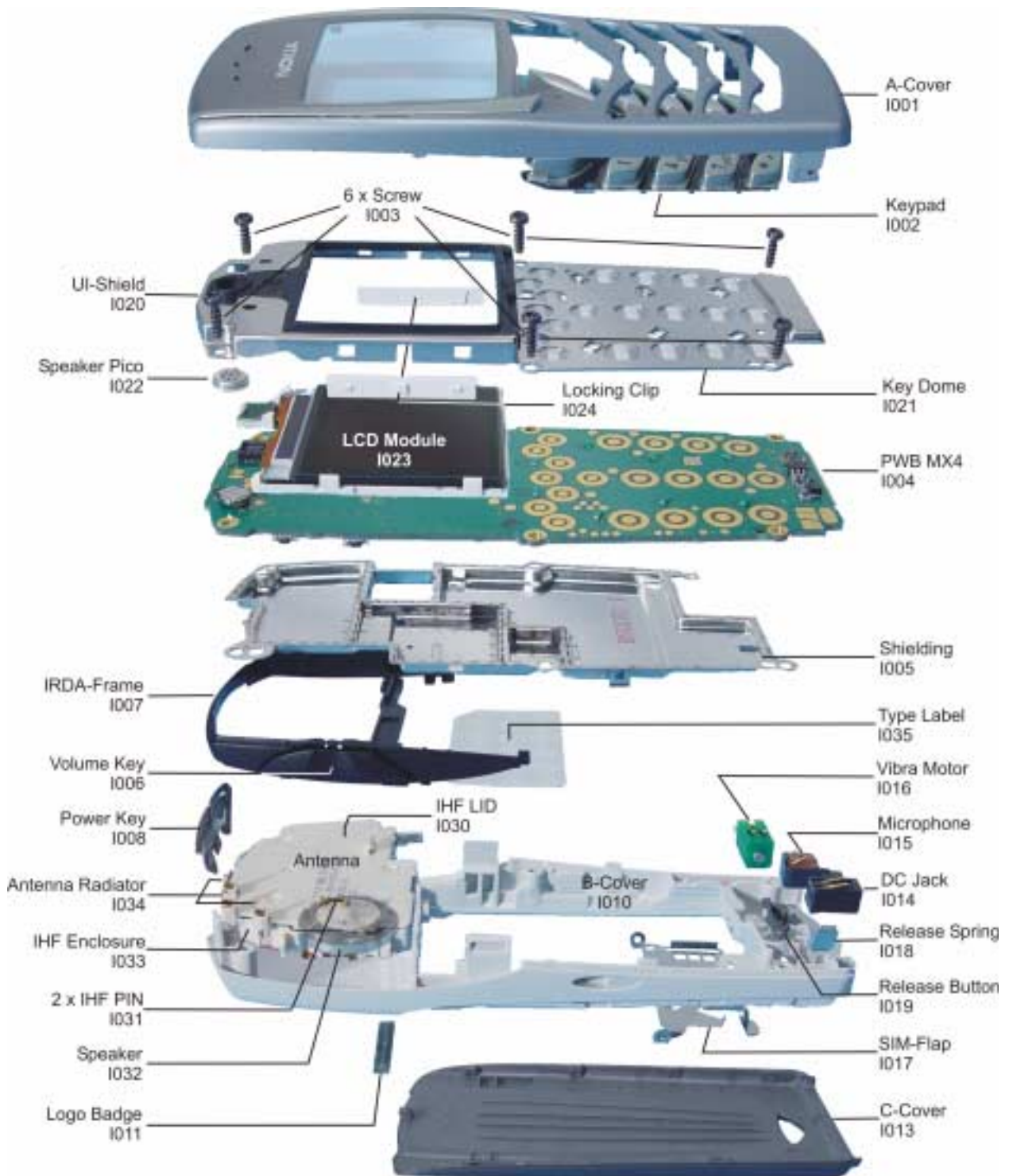

Assembly Parts List

Item	Description	NMP code
I001	A-cover assy DMC04602 light blue	9490854
I002	Keypad latin DMC04814 HDG13	9790673
I003	Screw 1,8x6	6290119
I004	PWB MX4	xxxxxxxxx
I005	Shielding assembly	9510919
I006	Volume key	xxxxxxxxx
I007	IRDA-Frame	xxxxxxxxx
	IRDA-Frame Assy	9458956
I008	Power key	9452315
I010	B-Cover	xxxxxxxxx
I011	Logo badge	9430211
	B-Cover Logo Assy	9458822
I012	BL-4C E/A	xxxxxxxxx
I013	C-cover painted	9490877
I014	DC-plug (Jack)	5400243
I015	Microphone	5140265
I016	Vib motor assy	6800057
I017	SIM-flap	9560199
I018	C-cover release spring	9510935
I019	C-cover release button	9452416
I020	UI-shield assy	xxxxxxxxx
I021	Key dome assy	xxxxxxxxx
	UI Shield Key Dome Assy	9491045
I022	Speaker pico	5140251
I023	LCD module	xxxxxxxxx
I024	Locking clip	xxxxxxxxx
	UI-Module	4850203
I030	IHF lid DMD08493 HDG13	xxxxxxxxx
I031	IHF pin DMD08352 NHL-4	xxxxxxxxx
I032	Speaker HF 69+-2DB 8R D16x4.36	xxxxxxxxx
I033	IHF enclosure DMD08492 HDG13	xxxxxxxxx
I034	Antenna radiator DMD08497 HDG13	xxxxxxxxx
	Antenna assy	xxxxxxxxx
I035	Type Label	xxxxxxxxx

Parts List Module ----- for NPL-2

PWB Components

Item	Product Code	Location Side, Grid ref.			Description and value				Type
B200	4510219	Bottom	M	6	CRYSTAL 32.768KHZ+-30PPM 9PF	32.768kHz	~	~	CRYSTAL_CX_4V
B601	4510337	Bottom	H	3	CRYSTAL 26.0MHZ+-8PPM CL=15.5	26MHz	~	~	CRYSTAL_TSX_8A
C100	2320546	Bottom	F	8	Chipcap 5% NP0	27p	50V	normal,-5%,5%	0402C
C101	2320139	Top	S	6	CHIPCAP X5R 1U0 K 10V 0603	1u0	10V	normal,-10%,10%	0603C_H0.95
C102	2320481	Top	T	7	CHIPCAP X5R 1U K 6V3 0603	1u0	6.3V	normal,-10%,10%	0603C
C103	2321013	Bottom	R	7	CHIPCAP NP0 270P J 25V 0402	270p	25V	normal,-5%,5%	0402C
C104	2320544	Bottom	R	7	Chipcap 5% NP0	22p	50V	normal,-5%,5%	0402C
C105	2320544	Bottom	Q	6	Chipcap 5% NP0	22p	50V	normal,-5%,5%	0402C
C106	2320744	Top	S	5	Chipcap X7R 10% 50V 0402	1n0	50V	normal,-10%,10%	0402C
C107	2320778	Top	S	7	Chipcap X7R 10% 16V 0402	10n	16V	normal,-10%,10%	0402C
C108	2320778	Top	S	7	Chipcap X7R 10% 16V 0402	10n	16V	normal,-10%,10%	0402C
C109	2320778	Top	S	7	Chipcap X7R 10% 16V 0402	10n	16V	normal,-10%,10%	0402C
C110	2320544	Top	T	5	Chipcap 5% NP0	22p	50V	normal,-5%,5%	0402C
C111	2320778	Top	S	7	Chipcap X7R 10% 16V 0402	10n	16V	normal,-10%,10%	0402C
C113	2320778	Top	T	6	Chipcap X7R 10% 16V 0402	10n	16V	normal,-10%,10%	0402C
C150	2312243	Bottom	N	7	CHIPCAP X5R 4U7 K 6V3 0805	4u7	6V3	normal,-10%,10%	0805C
C151	2320744	Bottom			Chipcap X7R 10% 50V 0402	1n0	50V	normal,-10%,10%	0402C
C152	2312243	Bottom	N	7	CHIPCAP X5R 4U7 K 6V3 0805	4u7	6V3	normal,-10%,10%	0805C
C153	2320783	Bottom	N	7	CHIPCAP X7R 33N K 10V 0402	33n	10V	normal,-20%,20%	0402C
C154	2320544	Bottom	R	4	Chipcap 5% NP0	22p	50V	normal,-5%,5%	0402C
C155	2320783	Bottom	N	6	CHIPCAP X7R 33N K 10V 0402	33n	10V	normal,-10%,10%	0402C
C156	2320544	Top	S	8	Chipcap 5% NP0	22p	50V	normal,-10%,10%	0402C
C157	2320544	Top	T	8	Chipcap 5% NP0	22p	50V	normal,-10%,10%	0402C

Item	Product Code	Location			Description and value				Type
		Side, Grid ref.							
C158	2320805	Bot- tom	M	6	CHIPCAP X5R 100N K 10V 0402	100n	10V	normal,-10%,10%	0402C
C159	2320783	Bot- tom	N	7	CHIPCAP X7R 33N K 10V 0402	33n	10V	normal,-20%,20%	0402C
C160	2320544	Bot- tom	N	6	Chipcap 5% NPO	22p	50V	normal,-5%,5%	0402C
C161	2320744	Bot- tom	N	6	Chipcap X7R 10% 50V 0402	1n0	50V	normal,-10%,10%	0402C
C162	2320805	Bot- tom	M	6	CHIPCAP X5R 100N K 10V 0402	100n	10V	normal,-10%,10%	0402C
C163	2320481	Bot- tom	0	6	CHIPCAP X5R 1U K 6V3 0603	1u0	6.3V	normal,-10%,10%	0603C
C164	2320544	Bot- tom	N	5	Chipcap 5% NPO	22p	50V	normal,-5%,5%	0402C
C165	2320544	Bot- tom	N	5	Chipcap 5% NPO	22p	50V	normal,-5%,5%	0402C
C166	2320783	Bot- tom	M	8	CHIPCAP X7R 33N K 10V 0402	33n	10V	normal,-20%,20%	0402C
C167	2320139	Bot- tom	N	5	CHIPCAP X5R 1U0 K 10V 0603	1u0	10V	normal,-10%,10%	0603C_H0.95
C168	2320805	Bot- tom	N	6	CHIPCAP X5R 100N K 10V 0402	100n	10V	normal,-10%,10%	0402C
C169	2320544	Bot- tom	N	6	Chipcap 5% NPO	22p	50V	normal,-5%,5%	0402C
C170	2320783	Bot- tom	N	7	CHIPCAP X7R 33N K 10V 0402	33n	10V	normal,-20%,20%	0402C
C171	2320744	Bot- tom	M	7	Chipcap X7R 10% 50V 0402	1n0	50V	normal,-10%,10%	0402C
C172	2320744	Bot- tom	N	7	Chipcap X7R 10% 50V 0402	1n0	50V	normal,-10%,10%	0402C
C173	2320744	Bot- tom	N	7	Chipcap X7R 10% 50V 0402	1n0	50V	normal,-10%,10%	0402C
C174	2320744	Bot- tom	M	8	Chipcap X7R 10% 50V 0402	1n0	50V	normal,-10%,10%	0402C
C175	2316001	Bot- tom	0	7	CHIPCAP X5R 2U2 K 6V3 0603	2u2	6V3	normal,-10%,10%	0603C
C176	2316001	Bot- tom	0	8	CHIPCAP X5R 2U2 K 6V3 0603	2u2	6V3	normal,-10%,10%	0603C
C177	2320552	Bot- tom	E	2	Chipcap 5% NPO	47p	50V	normal,-5%,5%	0402C
C178	2320552	Bot- tom	E	2	Chipcap 5% NPO	47p	50V	normal,-5%,5%	0402C
C179	2320544	Bot- tom	M	5	Chipcap 5% NPO	22p	50V	normal,-5%,5%	0402C
C180	2320544	Bot- tom	M	5	Chipcap 5% NPO	22p	50V	normal,-5%,5%	0402C
C181	2320544	Bot- tom	0	7	Chipcap 5% NPO	22p	50V	normal,-5%,5%	0402C

Item	Product Code	Location			Description and value				Type
		Side, Grid ref.							
C182	2320544	Bot-tom	0	7	Chipcap 5% NPO	22p	50V	normal,-5%,5%	0402C
C183	2316001	Bot-tom	0	7	CHIPCAP X5R 2U2 K 6V3 0603	2u2	6V3	normal,-10%,10%	0603C
C184	2316001	Bot-tom	0	8	CHIPCAP X5R 2U2 K 6V3 0603	2u2	6V3	normal,-10%,10%	0603C
C185	2320744	Bot-tom	M	7	Chipcap X7R 10% 50V 0402	1n0	50V	normal,-10%,10%	0402C
C200	2320805	Bot-tom	K	6	CHIPCAP X5R 100N K 10V 0402	100n	10V	normal,-10%,10%	0402C
C201	2320481	Bot-tom	K	5	CHIPCAP X5R 1U K 6V3 0603	1u0	6.3V	normal,-10%,10%	0603C
C202	2320778	Bot-tom	K	5	Chipcap X7R 10% 16V 0402	10n	16V	normal,-10%,10%	0402C
C203	2320481	Bot-tom	M	8	CHIPCAP X5R 1U K 6V3 0603	1u0	6.3V	normal,-10%,10%	0603C
C204	2320481	Bot-tom	K	6	CHIPCAP X5R 1U K 6V3 0603	1u0	6.3V	normal,-10%,10%	0603C
C205	2320481	Bot-tom	L	5	CHIPCAP X5R 1U K 6V3 0603	1u0	6.3V	normal,-10%,10%	0603C
C206	2320481	Bot-tom	L	6	CHIPCAP X5R 1U K 6V3 0603	1u0	6.3V	normal,-10%,10%	0603C
C207	2320481	Bot-tom	L	9	CHIPCAP X5R 1U K 6V3 0603	1u0	6.3V	normal,-10%,10%	0603C
C208	2320481	Bot-tom	K	6	CHIPCAP X5R 1U K 6V3 0603	1u0	6.3V	normal,-10%,10%	0603C
C209	2320536	Bot-tom	M	5	Chipcap 5% NPO	10p	50V	normal,-5%,5%	0402C
C210	2320536	Bot-tom	N	5	Chipcap 5% NPO	10p	50V	normal,-5%,5%	0402C
C211	2320481	Bot-tom	L	6	CHIPCAP X5R 1U K 6V3 0603	1u0	6.3V	normal,-10%,10%	0603C
C212	2320481	Bot-tom	P	5	CHIPCAP X5R 1U K 6V3 0603	1u0	6.3V	normal,-10%,10%	0603C
C213	2320481	Bot-tom	L	5	CHIPCAP X5R 1U K 6V3 0603	1u0	6.3V	normal,-10%,10%	0603C
C214	2320481	Bot-tom	L	6	CHIPCAP X5R 1U K 6V3 0603	1u0	6.3V	normal,-10%,10%	0603C
C215	2320481	Bot-tom	M	8	CHIPCAP X5R 1U K 6V3 0603	1u0	6.3V	normal,-10%,10%	0603C
C218	2320805	Bot-tom	K	9	CHIPCAP X5R 100N K 10V 0402	100n	10V	normal,-10%,10%	0402C
C219	2320139	Bot-tom	K	6	CHIPCAP X5R 1U0 K 10V 0603	1u0	10V	normal,-10%,10%	0603C_H0.95
C220	2320778	Bot-tom	M	5	Chipcap X7R 10% 16V 0402	10n	16V	normal,-10%,10%	0402C
C221	2320481	Bot-tom	J	6	CHIPCAP X5R 1U K 6V3 0603	1u0	6.3V	normal,-10%,10%	0603C

Item	Product Code	Location			Description and value				Type
		Side,	Grid	ref.					
C222	2320481	Bot- tom	J	7	CHIPCAP X5R 1U K 6V3 0603	1u0	6.3V	normal,-10%,10%	0603C
C223	2320481	Bot- tom	J	7	CHIPCAP X5R 1U K 6V3 0603	1u0	6.3V	normal,-10%,10%	0603C
C224	2320481	Bot- tom	J	7	CHIPCAP X5R 1U K 6V3 0603	1u0	6.3V	normal,-10%,10%	0603C
C225	2320481	Bot- tom	J	7	CHIPCAP X5R 1U K 6V3 0603	1u0	6.3V	normal,-10%,10%	0603C
C226	2320481	Bot- tom	J	7	CHIPCAP X5R 1U K 6V3 0603	1u0	6.3V	normal,-10%,10%	0603C
C227	2320481	Bot- tom	J	7	CHIPCAP X5R 1U K 6V3 0603	1u0	6.3V	normal,-10%,10%	0603C
C228	2320481	Bot- tom	J	8	CHIPCAP X5R 1U K 6V3 0603	1u0	6.3V	normal,-10%,10%	0603C
C229	2320481	Bot- tom	J	8	CHIPCAP X5R 1U K 6V3 0603	1u0	6.3V	normal,-10%,10%	0603C
C230	2320481	Bot- tom	J	8	CHIPCAP X5R 1U K 6V3 0603	1u0	6.3V	normal,-10%,10%	0603C
C231	2320481	Bot- tom	J	8	CHIPCAP X5R 1U K 6V3 0603	1u0	6.3V	normal,-10%,10%	0603C
C232	2320481	Bot- tom	J	8	CHIPCAP X5R 1U K 6V3 0603	1u0	6.3V	normal,-10%,10%	0603C
C234	2320481	Bot- tom	J	8	CHIPCAP X5R 1U K 6V3 0603	1u0	6.3V	normal,-10%,10%	0603C
C235	2320481	Bot- tom	L	6	CHIPCAP X5R 1U K 6V3 0603	1u0	6.3V	normal,-10%,10%	0603C
C236	2320805	Bot- tom	J	8	CHIPCAP X5R 100N K 10V 0402	100n	10V	normal,-10%,10%	0402C
C237	2320805	Bot- tom	J	9	CHIPCAP X5R 100N K 10V 0402	100n	10V	normal,-10%,10%	0402C
C238	2320805	Bot- tom	K	6	CHIPCAP X5R 100N K 10V 0402	100n	10V	normal,-10%,10%	0402C
C239	2320805	Bot- tom	K	9	CHIPCAP X5R 100N K 10V 0402	100n	10V	normal,-10%,10%	0402C
C240	2320778	Bot- tom	L	9	Chipcap X7R 10% 16V 0402	10n	16V	normal,-10%,10%	0402C
C242	2320744	Bot- tom	L	9	Chipcap X7R 10% 50V 0402	1n0	50V	normal,-20%,20%	0402C
C243	2320481	Bot- tom	L	5	CHIPCAP X5R 1U K 6V3 0603	1u0	6.3V	normal,-10%,10%	0603C
C260	2320481	Bot- tom	I	7	CHIPCAP X5R 1U K 6V3 0603	1u0	6.3V	normal,-10%,10%	0603C
C261	2320481	Bot- tom	J	5	CHIPCAP X5R 1U K 6V3 0603	1u0	6.3V	normal,-10%,10%	0603C
C262	2320481	Bot- tom	I	7	CHIPCAP X5R 1U K 6V3 0603	1u0	6.3V	normal,-10%,10%	0603C
C263	2320481	Bot- tom	I	7	CHIPCAP X5R 1U K 6V3 0603	1u0	6.3V	normal,-10%,10%	0603C

Item	Product Code	Location			Description and value				Type
		Side, Grid ref.							
C264	2320481	Bot- tom	I	7	CHIPCAP X5R 1U K 6V3 0603	1u0	6.3V	normal,-10%,10%	0603C
C265	2320481	Bot- tom	I	8	CHIPCAP X5R 1U K 6V3 0603	1u0	6.3V	normal,-10%,10%	0603C
C300	2320805	Top	A	6	CHIPCAP X5R 100N K 10V 0402	100n	10V	normal,-10%,10%	0402C
C301	2320805	Top	B	6	CHIPCAP X5R 100N K 10V 0402	100n	10V	normal,-10%,10%	0402C
C302	2320556	Bot- tom	O	9	Chipcap 5% NP0	68p	50V	normal,-5%,5%	0402C
C303	2320481	Bot- tom	O	8	CHIPCAP X5R 1U K 6V3 0603	1u0	6.3V	normal,-10%,10%	0603C
C304	2312411	Bot- tom	M	9	CHIPCAP X5R 1U0 M 25V 1206	1u0	25V	normal,-20%,20%	1206_BLM
C306	2320778	Bot- tom	Q	5	Chipcap X7R 10% 16V 0402	10n	16V	normal,-10%,10%	0402C
C310	2320544	Bot- tom	A	5	Chipcap 5% NP0	22p	50V	normal,-5%,5%	0402C
C312	2320544	Bot- tom	E	3	Chipcap 5% NP0	22p	50V	normal,-5%,5%	0402C
C313	2320544	Top	B	5	Chipcap 5% NP0	22p	50V	normal,-5%,5%	0402C
C350	2312243	Bot- tom	J	9	CHIPCAP X5R 4U7 K 6V3 0805	4u7	6V3	normal,-10%,10%	0805C
C352	2320805	Bot- tom	F	8	CHIPCAP X5R 100N K 10V 0402	100n	10V	normal,-10%,10%	0402C
C353	2320805	Bot- tom	G	8	CHIPCAP X5R 100N K 10V 0402	100n	10V	normal,-10%,10%	0402C
C400	2320778	Bot- tom	M	5	Chipcap X7R 10% 16V 0402	10n	16V	normal,-10%,10%	0402C
C401	2320805	Bot- tom	M	5	CHIPCAP X5R 100N K 10V 0402	100n	10V	normal,-10%,10%	0402C
C402	2320778	Bot- tom	L	5	Chipcap X7R 10% 16V 0402	10n	16V	normal,-10%,10%	0402C
C403	2320778	Bot- tom	N	5	Chipcap X7R 10% 16V 0402	10n	16V	normal,-10%,10%	0402C
C404	2320778	Bot- tom	M	5	Chipcap X7R 10% 16V 0402	10n	16V	normal,-10%,10%	0402C
C405	2320778	Bot- tom	L	5	Chipcap X7R 10% 16V 0402	10n	16V	normal,-10%,10%	0402C
C420	2320552	Bot- tom	L	5	Chipcap 5% NP0	47p	50V	normal,-5%,5%	0402C
C426	2320744	Bot- tom	K	5	Chipcap X7R 10% 50V 0402	1n0	50V	normal,-10%,10%	0402C
C450	2320778	Bot- tom	Q	5	Chipcap X7R 10% 16V 0402	10n	16V	normal,-10%,10%	0402C
C451	2320805	Bot- tom	Q	5	CHIPCAP X5R 100N K 10V 0402	100n	10V	normal,-10%,10%	0402C

Item	Product Code	Location			Description and value				Type
		Side, Grid ref.							
C454	2320779	Bot- tom	P	5	CHIPCAP X7R 100N K 16V 0603	100n	16V	normal,-10%,10%	0603_BLM
C601	2320629	Bot- tom	B	4	CHIPCAP NP0 1P0 B 50V 0402	1p0	50V	normal,-0.1p,0.1p	0402C
C602	2320629	Bot- tom	C	4	CHIPCAP NP0 1P0 B 50V 0402	1p0	50V	normal,-0.1p,0.1p	0402C
C603	2320744	Bot- tom	H	3	Chipcap X7R 10% 50V 0402	1n0	50V	normal,-10%,10%	0402C
C605	2320805	Bot- tom	I	3	CHIPCAP X5R 100N K 10V 0402	100n	10V	normal,-10%,10%	0402C
C606	2320546	Bot- tom	H	3	Chipcap 5% NP0	27p	50V	normal,-5%,5%	0402C
C607	2312211	Bot- tom	G	3	CHIPCAP X5R 3U3 K 6V3 0805	3u3	6V3	normal,-10%,10%	0805C_H1.35
C610	2320805	Bot- tom	K	4	CHIPCAP X5R 100N K 10V 0402	100n	10V	normal,-10%,10%	0402C
C615	2320778	Bot- tom	G	3	Chipcap X7R 10% 16V 0402	10n	16V	normal,-10%,10%	0402C
C620	2320546	Bot- tom	G	3	Chipcap 5% NP0	27p	50V	normal,-5%,5%	0402C
C621	2320552	Bot- tom	I	3	Chipcap 5% NP0	47p	50V	normal,-5%,5%	0402C
C622	2320805	Bot- tom	I	3	CHIPCAP X5R 100N K 10V 0402	100n	10V	normal,-10%,10%	0402C
C623	2320805	Bot- tom	I	4	CHIPCAP X5R 100N K 10V 0402	100n	10V	normal,-10%,10%	0402C
C624	2320546	Bot- tom	H	5	Chipcap 5% NP0	27p	50V	normal,-5%,5%	0402C
C625	2320481	Bot- tom	I	4	CHIPCAP X5R 1U K 6V3 0603	1u0	6.3V	normal,-10%,10%	0603C
C626	2320522	Bot- tom	G	5	Chipcap +-0.25pF NP0	2p7	50V	normal,- 0.25pF,0.25pF	0402C
C627	2313213	Bot- tom	I	3	CHIPCAP X5R 10U K 6V3 1206	10u	6.3V	normal,-10%,10%	1206C_H1.8
C628	2320778	Bot- tom	I	4	Chipcap X7R 10% 16V 0402	10n	16V	normal,-10%,10%	0402C
C629	2320546	Bot- tom	I	5	Chipcap 5% NP0	27p	50V	normal,-5%,5%	0402C
C630	2320629	Bot- tom	F	4	CHIPCAP NP0 1P0 B 50V 0402	1p0	50V	normal,-0.1p,0.1p	0402C
C631	2320629	Bot- tom	F	5	CHIPCAP NP0 1P0 B 50V 0402	1p0	50V	normal,-0.1p,0.1p	0402C
C632	2320805	Bot- tom	H	3	CHIPCAP X5R 100N K 10V 0402	100n	10V	normal,-10%,10%	0402C
C633	2320546	Bot- tom	I	5	Chipcap 5% NP0	27p	50V	normal,-5%,5%	0402C
C634	2320522	Bot- tom	F	4	Chipcap +-0.25pF NP0	2p7	50V	normal,- 0.25pF,0.25pF	0402C

Item	Product Code	Location			Description and value				Type
		Side, Grid ref.							
C635	2320546	Bot- tom	I	4	Chipcap 5% NPO	27p	50V	normal,-5%,5%	0402C
C636	2320778	Bot- tom	H	3	Chipcap X7R 10% 16V 0402	10n	16V	normal,-10%,10%	0402C
C637	2320778	Bot- tom	I	4	Chipcap X7R 10% 16V 0402	10n	16V	normal,-10%,10%	0402C
C701	2320532	Bot- tom	C	4	Chipcap +-0.25pF NPO	6p8	50V	normal,- 0.25pF,0.25pF	0402C
C702	2320532	Bot- tom	E	5	Chipcap +-0.25pF NPO	6p8	50V	normal,- 0.25pF,0.25pF	0402C
C703	2320546	Bot- tom	C	4	Chipcap 5% NPO	27p	50V	normal,-5%,5%	0402C
C705	2322023	Bot- tom	I	6	CHIPCAP NPO 2N2 J 16V 0603	2n2	16V	normal,-5%,5%	0603C
C706	2320556	Bot- tom	I	6	Chipcap 5% NPO	68p	50V	normal,-5%,5%	0402C
C709	2320631	Bot- tom	I	5	CHIPCAP NPO 180P J 25V 0402	180p	25V	normal,-5%,5%	0402C
C710	2320631	Bot- tom	I	5	CHIPCAP NPO 180P J 25V 0402	180p	25V	normal,-5%,5%	0402C
C711	2310055	Bot- tom	I	5	CHIPCAP NPO 3N9 J 25V 0805	3n9	25V	normal,-5%,5%	0805C_AVX
C712	2320631	Bot- tom	K	3	CHIPCAP NPO 180P J 25V 0402	180p	25V	normal,-5%,5%	0402C
C715	2320556	Bot- tom	I	4	Chipcap 5% NPO	68p	50V	normal,-5%,5%	0402C
C716	2320556	Bot- tom	I	4	Chipcap 5% NPO	68p	50V	normal,-5%,5%	0402C
C717	2320546	Bot- tom	I	5	Chipcap 5% NPO	27p	50V	normal,-5%,5%	0402C
C718	2320744	Bot- tom	I	5	Chipcap X7R 10% 50V 0402	1n0	50V	normal,-10%,10%	0402C
C721	2320744	Bot- tom	G	6	Chipcap X7R 10% 50V 0402	1n0	50V	normal,-10%,10%	0402C
C722	2320540	Bot- tom	F	6	Chipcap 5% NPO	15p	50V	normal,-5%,5%	0402C
C723	2320540	Bot- tom	F	6	Chipcap 5% NPO	15p	50V	normal,-5%,5%	0402C
C731	2320550	Bot- tom	G	5	Chipcap 5% NPO	39p	50V	normal,-5%,5%	0402C
C740	2312211	Bot- tom	K	4	CHIPCAP X5R 3U3 K 6V3 0805	3u3	6V3	normal,-10%,10%	3u3
C741	2320621	Bot- tom	K	3	CHIPCAP NPO 0P5 C 50V 0402	0p5	50V	normal,- 0.25p,0.25p	0402C
C801	2320602	Bot- tom	E	5	Chipcap +-0.25pF NPO	4p7	50V	normal,- 0.25pF,0.25pF	0402C
C802	2320546	Bot- tom	C	5	Chipcap 5% NPO	27p	50V	normal,-5%,5%	0402C

Item	Product Code	Location			Description and value				Type
		Side, Grid ref.							
C803	2320546	Bot-tom	C	4	Chipcap 5% NPO	27p	50V	normal,-5%,5%	0402C
C804	2320546	Bot-tom	C	5	Chipcap 5% NPO	27p	50V	normal,-5%,5%	0402C
C805	2320546	Bot-tom	B	5	Chipcap 5% NPO	27p	50V	normal,-5%,5%	0402C
C810	2320602	Bot-tom	D	5	Chipcap +-0.25pF NPO	4p7	50V	normal,-0.25pF,0.25pF	0402C
C811	2320744	Bot-tom	C	5	Chipcap X7R 10% 50V 0402	1n0	50V	normal,-10%,10%	0402C
C812	2310793	Bot-tom	I	9	CHIPCAP X5R 2U2 K 10V 0805	2u2	10V	normal,-10%,10%	0805C
C813	2320524	Bot-tom	D	5	Chipcap +-0.25pF NPO	3p3	50V	normal,-0.25pF,0.25pF	0402C
C814	2320548	Bot-tom	C	5	Chipcap 5% NPO	33p	50V	normal,-5%,5%	0402C
C815	2611753	Bot-tom	H	7	CHIPTCAP 33U M 16V 6.0X3.2X1.5	33u_16V	16V	normal,-20%,20%	TANT_TPSW2
C816	2320604	Bot-tom	H	9	Chipcap 5% NPO	18p	50V	normal,-5%,5%	0402C
C817	2320602	Bot-tom	H	9	Chipcap +-0.25pF NPO	4p7	50V	normal,-0.25pF,0.25pF	0402C
C818	2320546	Bot-tom	D	8	Chipcap 5% NPO	27p	50V	normal,-5%,5%	0402C
C819	2611753	Bot-tom	B	7	CHIPTCAP 33U M 16V 6.0X3.2X1.5	33u_16V	16V	normal,-20%,20%	TANT_TPSW2
C820	2320546	Bot-tom	C	9	Chipcap 5% NPO	27p	50V	normal,-5%,5%	0402C
C821	2320518	Bot-tom	D	9	Chipcap +-0.25pF NPO	1p8	50V	normal,-0.25pF,0.25pF	0402C
C822	2320546	Bot-tom	D	9	Chipcap 5% NPO	27p	50V	normal,-5%,5%	0402C
C824	2320526	Bot-tom	E	9	Chipcap +-0.25pF NPO	3p9	50V	normal,-0.25pF,0.25pF	0402C
C825	2320805	Bot-tom	E	6	CHIPCAP X5R 100N K 10V 0402	100n	10V	normal,-10%,10%	0402C
C826	2320805	Bot-tom	B	6	CHIPCAP X5R 100N K 10V 0402	100n	10V	normal,-10%,10%	0402C
C835	2320514	Bot-tom	F	8	Chipcap +-0.25pF NPO	1p2	50V	normal,-0.25pF,0.25pF	0402C
C836	2320524	Bot-tom	F	8	Chipcap +-0.25pF NPO	3p3	50V	normal,-0.25pF,0.25pF	0402C
C837	2320552	Bot-tom	F	8	Chipcap 5% NPO	47p	50V	normal,-5%,5%	0402C
C872	2320805	Bot-tom	G	3	CHIPCAP X5R 100N K 10V 0402	100n	10V	normal,-10%,10%	0402C
D200	4370825	Bot-tom	L	7	UEMK 4.4 W-DOG ENA TO21 TFBGA168	~	~	~	uBGA168

Item	Product Code	Location			Description and value				Type
		Side, Grid ref.							
D400	4370873	Bot- tom	M	4	UPP8M V2.2 F751986B C035	~	~	~	UBGA144
D450	4341441	Bot- tom	P	4	COMBO 64M NOR+4M SRAM TBGA48	4Mx16/ 256kx16	~	~	uBGA40_XTYPE_10X8
F100	5119019	Top	S	4	SM FUSE F 1.5A 32V 0603	1.5A		~	0603_FUSE
G300	4700131	Top	B	4	CELL CAPACITOR 0.01MAH 3V3	3V3		~	XH414_I102N
G701	4350315	Bot- tom	K	3	VCO 3420-3980MHZ 2.7V 19MA	3420- 3980MHz		~	VCO_FDK_IT_H1.7
L100	3203705	Top	S	5	FERRITE BEAD 42R/ 100MHZ 0805	42R/ 100MHz		~	0805_FERRITE
L102	3203801	Top	T	7	CHIP BEAD ARRAY 2X1000R 0405	2x1000R/ 100MHz		~	0405_2_MATSU
L103	3203801	Top	T	7	CHIP BEAD ARRAY 2X1000R 0405	2x1000R/ 100MHz		~	0405_2_MATSU
L106	3203725	Top	T	6	FERRITE BEAD 0R6 600R/ 100M 0402	600R/ 100MHz		~	FERRITE_0402
L107	3203741	Top	S	5	FERRITE BEAD 0R5 600R/ 100MHZ 0603	600R/ 100MHz	~	~	0603_BLM
L150	3203801	Top	B	5	CHIP BEAD ARRAY 2X1000R 0405	2x1000R/ 100MHz		~	0405_2_MATSU
L151	3203715	Bot- tom	E	2	FERRITE BEAD 0R35 240R/ 100M 0402	240R/ 100MHz		~	FERRITE_BK1005
L152	3203715	Bot- tom	D	2	FERRITE BEAD 0R35 240R/ 100M 0402	240R/ 100MHz		~	FERRITE_BK1005
L153	3203725	Bot- tom	R	4	FERRITE BEAD 0R6 600R/ 100M 0402	600R/ 100MHz		~	FERRITE_0402
L260	3203741	Bot- tom	I	7	FERRITE BEAD 0R5 600R/ 100MHZ 0603	600R/ 100MHz	~	~	0603_BLM
L261	3203741	Bot- tom	J	6	FERRITE BEAD 0R5 600R/ 100MHZ 0603	600R/ 100MHz	~	~	0603_BLM
L262	3203741	Bot- tom	I	7	FERRITE BEAD 0R5 600R/ 100MHZ 0603	600R/ 100MHz	~	~	0603_BLM
L263	3203741	Bot- tom	I	7	FERRITE BEAD 0R5 600R/ 100MHZ 0603	600R/ 100MHz	~	~	0603_BLM
L264	3203741	Bot- tom	I	7	FERRITE BEAD 0R5 600R/ 100MHZ 0603	600R/ 100MHz	~	~	0603_BLM
L265	3203741	Bot- tom	I	8	FERRITE BEAD 0R5 600R/ 100MHZ 0603	600R/ 100MHz	~	~	0603_BLM
L300	3640119	Bot- tom	N	8	CHOKE 22U M 1R4 0.33A 3.3X3.3X1.5	22uH		~	CHOKE_984FB
L351	3203747	Bot- tom	Q	8	FERRITE BEAD 0R8 75R/ 100MHZ 0402	75R/ 100MHz	~	~	0402L
L601	3646087	Bot- tom	G	4	CHIP COIL 1N8+-0N3 Q31/ 800M 0402	1n8H	~	normal,-0n3,0n3	0402L
L602	3646087	Bot- tom	G	4	CHIP COIL 1N8+-0N3 Q31/ 800M 0402	1n8H	~	normal,-0n3,0n3	0402L

Item	Product Code	Location Side, Grid ref.			Description and value				Type
L603	3646005	Bot- tom	G	5	CHIP COIL 2N7+-0N3 Q29/ 800M 0402	2n7H	~	normal,-0n3,0n3	0402L
L604	3646005	Bot- tom	G	5	CHIP COIL 2N7+-0N3 Q29/ 800M 0402	2n7H	~	normal,-0n3,0n3	0402L
L606	3646055	Bot- tom	G	4	CHIP COIL 8N2 J Q28/ 800MHZ 0402	8n2H	~	normal,-5%,+5%	0402L
L607	3646055	Bot- tom	G	4	CHIP COIL 8N2 J Q28/ 800MHZ 0402	8n2H	~	normal,-5%,+5%	0402L
L608	3646051	Bot- tom	C	4	CHIP COIL 3N9 +-0N3 Q28/ 800M 0402	3n9H	~	normal,-0n3,+0n3	0402L
L705	3646131	Bot- tom	G	6	CHIP COIL 3N9 +-0N1 Q28/ 1GHZ 0402	3n9H		~	0402L_W065_POL
L706	3646061	Bot- tom	G	6	CHIP COIL 15N J Q30/800M 0402	15nH	~	normal,-5%,5%	0402L
L707	3646061	Bot- tom	G	5	CHIP COIL 15N J Q30/800M 0402	15nH	~	normal,-5%,5%	0402L
L708	3646061	Bot- tom	G	6	CHIP COIL 15N J Q30/800M 0402	15nH	~	normal,-5%,5%	0402L
L711	3646069	Bot- tom	H	5	CHIP COIL 33N J Q23/800M 0402	33nH	~	normal,-5%,5%	0402L
L712	3646117	Bot- tom	F	6	CHIP COIL 5N6 +-0N1 Q26/ 1GHZ 0402	5n6H		~	0402L_H0.45
L730	3646051	Bot- tom	K	4	CHIP COIL 3N9 +-0N3 Q28/ 800M 0402	3n9H	~	normal,-0n3,+0n3	0402L
L732	3646005	Bot- tom	H	5	CHIP COIL 2N7+-0N3 Q29/ 800M 0402	2n7H	~	normal,-0n3,0n3	0402L
L733	3646005	Bot- tom	G	6	CHIP COIL 2N7+-0N3 Q29/ 800M 0402	2n7H	~	normal,-0n3,0n3	0402L
L801	4551015	Bot- tom	D	5	DIR.COUP 897.5/1747.5/ 1880MHZ	897.5/ 1747.5/ 1880M		~	COUPLER_LDC15D
L804	3203705	Bot- tom	H	8	FERRITE BEAD 42R/ 100MHZ 0805	42R/ 100MHz		~	0805_FERRITE
L805	3203705	Bot- tom	I	8	FERRITE BEAD 42R/ 100MHZ 0805	42R/ 100MHz		~	0805_FERRITE
L806	3646009	Bot- tom	C	9	CHIP COIL 10N J Q30/800M 0402	10nH	~	normal,-5%,5%	0402L
L807	3646059	Bot- tom	D	9	CHIP COIL 5N6 +-0N3 Q28/ 800M 0402	5n6H	~	normal,-0n3,+0n3	0402L
L932	3646005	Bot- tom			CHIP COIL 2N7+-0N3 Q29/ 800M 0402	2n7H	~	normal,-0n3,0n3	0402L
L933	3646005	Bot- tom			CHIP COIL 2N7+-0N3 Q29/ 800M 0402	2n7H	~	normal,-0n3,0n3	0402L
N100	4341063	Top	T	6	REG 2.8V/150MA LP3985 SOT23-5	~	2.8V		SOT23_5_H1.2
N150	4341221	Bot- tom	0	6	AF AMP 0.4W/2.6V LM4890 USMD9	~	~		USMD9_AAB

Item	Product Code	Location			Description and value	Type			
		Side, Grid ref.							
N300	4341309	Bot- tom	N	9	DC/DC CONV 350MA TK11851 SSOP8	~	~	~	SOT23L_8
N350	4860121	Bot- tom			IRDA RPM960-H7 1.152MB/S >2.4V	~	~	~	IRDA_RPM870_H7
N601	4370867	Bot- tom	G	4	MJOELNER RF ASIC S2006 LFBGA80	~	~	~	LFBGA_80
N801	4350369	Bot- tom	D	7	PW AMP QCPM-8893 900/ 1800/1900MHZ	~	~		PW_AMP_PA_HDG13
R100	1620027	Bot- tom	R	6	RES NETWORK 0W06 2X47R J 0404	2x47R	~		0404_R_SR
R101	1620027	Bot- tom	R	7	RES NETWORK 0W06 2X47R J 0404	2x47R	~		0404_R_SR
R102	1620027	Bot- tom	R	7	RES NETWORK 0W06 2X47R J 0404	2x47R	~		0404_R_SR
R103	4120011	Bot- tom	R	6	ZDIX4 IP4043CX5 CA 14V2 10W CSP5	~	~	~	uBGA5
R104	1430812	Bot- tom	R	6	Resistor 5% 63mW	220k	~	normal,-5%,5%	0402R
R105	1825031	Top	T	8	VARISTOR ARRAY 2XVWM16V VC50 0405	2XVWM16V	~	~	0405_2
R106	1820039	Bot- tom	0	5	NTC RES 47K J B=4050+- 3% 0402	47k	~		0402_NTH5
R107	1430804	Top	T	6	Resistor 5% 63mW	100k	~	normal,-5%,5%	0402R
R109	1430804	Bot- tom	R	7	Resistor 5% 63mW	100k	~	normal,-5%,5%	0402R
R110	1825031	Bot- tom	R	7	VARISTOR ARRAY 2XVWM16V VC50 0405	2XVWM16V	~	~	0405_2
R151	1825031	Top	A	5	VARISTOR ARRAY 2XVWM16V VC50 0405	2XVWM16V	~	~	0405_2
R153	1620105	Bot- tom	N	7	RES NETWORK 0W06 2X2k2 J 0404	2x2k2	~	~	MNR02
R155	1825031	Bot- tom	R	3	VARISTOR ARRAY 2XVWM16V VC50 0405	2XVWM16V	~	~	0405_2
R156	1430762	Bot- tom	0	7	Resistor 5% 63mW	2k2	~	normal,-5%,5%	0402R
R158	1430752	Bot- tom	0	8	Resistor 5% 63mW	820R	~	normal,-5%,5%	0402R
R159	1430754	Bot- tom	N	7	Resistor 5% 63mW	1k0	~	normal,-5%,5%	0402R
R160	1430734	Bot- tom	0	7	Resistor 5% 63mW	220R	~	normal,-5%,5%	0402R
R162	1620105	Bot- tom	N	7	RES NETWORK 0W06 2X2k2 J 0404	2x2k2	~	~	MNR02
R163	1430786	Bot- tom	N	6	Resistor 5% 63mW	18k	~	normal,-5%,5%	0402R
R164	1430762	Bot- tom	N	6	Resistor 5% 63mW	2k2	~	normal,-5%,5%	0402R

Item	Product Code	Location Side, Grid ref.			Description and value				Type
R165	1430762	Bot- tom	N	6	Resistor 5% 63mW	2k2	~	normal,-5%,5%	0402R
R166	1430786	Bot- tom	0	6	Resistor 5% 63mW	18k	~	normal,-5%,5%	0402R
R167	1430778	Bot- tom	N	6	Resistor 5% 63mW	10k	~	normal,-5%,5%	0402R
R168	1430804	Bot- tom	0	5	Resistor 5% 63mW	100k	~	normal,-5%,5%	0402R
R171	1430754	Bot- tom	0	8	Resistor 5% 63mW	1k0	~	normal,-5%,5%	0402R
R172	1430790	Bot- tom	M	7	Resistor 5% 63mW	27k	~	normal,-5%,5%	0402R
R173	1430734	Bot- tom	0	8	Resistor 5% 63mW	220R	~	normal,-5%,5%	0402R
R200	1419003	Bot- tom	K	5	CHIPRES 0W5 0R22 J 1210	0R22	~	normal,-5%,5%	1210_R
R202	1620043	Bot- tom	L	9	RES NETWORK 0W03 4X100K J 0804	4x100k	~	~	EXB28V
R206	1430770	Bot- tom	L	9	Resistor 5% 63mW	4k7	~	normal,-5%,5%	0402R
R207	1430770	Bot- tom	M	5	Resistor 5% 63mW	4k7	~	normal,-5%,5%	0402R
R300	1430712	Bot- tom	N	9	Resistor 5% 63mW	27R	~	normal,-5%,5%	0402R
R301	1430734	Bot- tom	J	9	Resistor 5% 63mW	220R	~	normal,-5%,5%	0402R
R302	1430726	Bot- tom	0	9	Resistor 5% 63mW	100R	~	normal,-5%,5%	0402R
R303	1430726	Bot- tom	Q	7	Resistor 5% 63mW	100R	~	normal,-5%,5%	0402R
R306	1430790	Bot- tom	B	5	Resistor 5% 63mW	27k	~	normal,-5%,5%	0402R
R308	1430734	Bot- tom	F	7	Resistor 5% 63mW	220R	~	normal,-5%,5%	0402R
R309	1430734	Bot- tom	F	7	Resistor 5% 63mW	220R	~	normal,-5%,5%	0402R
R310	1430734	Bot- tom	F	7	Resistor 5% 63mW	220R	~	normal,-5%,5%	0402R
R311	1430726	Bot- tom	M	9	Resistor 5% 63mW	100R	~	normal,-5%,5%	0402R
R350	1419009	Bot- tom	I	8	CHIPRES 0W5 4R7 J 1210	4R7	~	normal,-5%,5%	1210_R
R388	4120071	Bot- tom	0	8	ASIP EMIF03-SIM01 SIM FILTER BGA8	~	~	~	uBGA8
R420	1430754	Bot- tom	K	5	Resistor 5% 63mW	1k0	~	normal,-5%,5%	0402R
R422	1430790	Bot- tom	J	8	Resistor 5% 63mW	27k	~	normal,-5%,5%	0402R

Item	Product Code	Location			Description and value				Type
		Side, Grid ref.							
R426	1430754	Bot-tom	K	5	Resistor 5% 63mW	1k0	~	normal,-5%,5%	0402R
R450	1430770	Bot-tom	P	5	Resistor 5% 63mW	4k7	~	normal,-5%,5%	0402R
R610	1430718	Bot-tom	G	3	Resistor 5% 63mW	47R	~	normal,-5%,5%	0402R
R612	1430754	Bot-tom	G	3	Resistor 5% 63mW	1k0	~	normal,-5%,5%	0402R
R617	1430718	Bot-tom	I	3	Resistor 5% 63mW	47R	~	normal,-5%,5%	0402R
R623	1430726	Bot-tom	I	5	Resistor 5% 63mW	100R	~	normal,-5%,5%	0402R
R625	1430718	Bot-tom	I	4	Resistor 5% 63mW	47R	~	normal,-5%,5%	0402R
R626	1430846	Bot-tom	G	3	Resistor 1% 63mW	2k7	~	normal,-1%,1%	0402R
R628	1430693	Bot-tom	H	5	Chipres 0W06 5R6 J 0402	5R6	~	normal,-5%,5%	0402R
R629	1430693	Bot-tom	I	4	Chipres 0W06 5R6 J 0402	5R6	~	normal,-5%,5%	0402R
R630	1430718	Bot-tom	I	4	Resistor 5% 63mW	47R	~	normal,-5%,5%	0402R
R706	1430792	Bot-tom	I	5	Resistor 5% 63mW	33k	~	normal,-5%,5%	0402R
R707	1430778	Bot-tom	I	6	Resistor 5% 63mW	10k	~	normal,-5%,5%	0402R
R708	1430770	Bot-tom	I	6	Resistor 5% 63mW	4k7	~	normal,-5%,5%	0402R
R710	1430865	Bot-tom	I	5	CHIPRES 0W06 5K6 F 0402	5k6	~	normal,-1%,1%	0402R
R711	1430776	Bot-tom	K	3	Resistor 5% 63mW	8k2	~	normal,-5%,5%	0402R
R713	1620065	Bot-tom	I	4	RES NETWORK 0W06 4X5K6 J 0804	4x5.6k	~	normal,-5%,5%	MNRO4
R717	1620105	Bot-tom	I	6	RES NETWORK 0W06 2X2K2 J 0404	2x2k2	~	normal,-5%,5%	MNRO2_SR
R720	1430730	Bot-tom	G	6	Resistor 5% 63mW	150R	~	normal,-5%,5%	0402R
R721	1430730	Bot-tom	G	5	Resistor 5% 63mW	150R	~	normal,-5%,5%	0402R
R725	1430724	Bot-tom	G	5	Resistor 5% 63mW	82R	~	normal,-5%,5%	0402R
R726	1430724	Bot-tom	G	6	Resistor 5% 63mW	82R	~	normal,-5%,5%	0402R
R729	1620507	Bot-tom	E	9	RES NETWORK 0W04 3DB ATT 0404	292R/17R6/292R	~		0404_RAC10
R731	1620507	Bot-tom	J	4	RES NETWORK 0W04 3DB ATT 0404	292R/17R6/292R	~		0404_RAC10

Item	Product Code	Location Side, Grid ref.			Description and value				Type
R801	1430770	Bottom	C	5	Resistor 5% 63mW	4k7	~	normal,-5%,5%	0402R
R802	1430726	Bottom	C	5	Resistor 5% 63mW	100R	~	normal,-5%,5%	0402R
R803	1430718	Bottom	D	5	Resistor 5% 63mW	47R	~	normal,-5%,5%	0402R
R805	1620517	Bottom	C	8	RES NETWORK 0W04 6DB ATT 0404	150R/37R4/150R	~		0404_RAC10
R817	1430754	Bottom	C	8	Resistor 5% 63mW	1k0	~	normal,-5%,5%	0402R
R818	1430726	Bottom	C	8	Resistor 5% 63mW	100R	~	normal,-5%,5%	0402R
R819	1620507	Bottom	E	8	RES NETWORK 0W04 3DB ATT 0404	292R/17R6/292R	~		0404_RAC10
R820	1430754	Bottom	D	8	Resistor 5% 63mW	1k0	~	normal,-5%,5%	0402R
R821	1430726	Bottom	D	8	Resistor 5% 63mW	100R	~	normal,-5%,5%	0402R
R822	1430766	Bottom	D	9	Resistor 5% 63mW	3k9	~	normal,-5%,5%	0402R
R823	1430732	Bottom	E	9	Resistor 5% 63mW	180R	~	normal,-5%,5%	0402R
R999	1430690	Bottom			Jumper	0R	~	~	0402R
S300	5200025	Bottom	D	3	SM TACT SW SIDE TRAVEL 0.2MM	~	~		SWITCH_SKRE
S301	5200025	Bottom	F	2	SM TACT SW SIDE TRAVEL 0.2MM	~	~		SWITCH_SKRE
S302	5200025	Bottom	A	6	SM TACT SW SIDE TRAVEL 0.2MM	~	~		SWITCH_SKRE
T701	4550191	Bottom	F	6	TRANSF BALUN 1800+-100MHZ 2X1.25	~	~		TRANS_LDB213
T702	4550179	Bottom	I	5	BALUN TRANS 3.7GHZ+/-300MHZ 0805	~	~		TRANS_LDB15
V100	4113721	Top	T	5	TVS DI 1PMT16AT3 16V 175W PWRMITE	~	~	~	CASE_457
V300	4110475	Bottom	N	8	SCH DI RB521S-30 200MA 35V SOD523	~	~	~	EMD2
V310	4864581	Top	R	4	LED CL191PSB68 PASTELBLUE 0' 0603	~	~		LED_CL191
V311	4864581	Top	R	7	LED CL191PSB68 PASTELBLUE 0' 0603	~	~		LED_CL191
V312	4864581	Top	O	4	LED CL191PSB68 PASTELBLUE 0' 0603	~	~		LED_CL191
V313	4864581	Top	O	7	LED CL191PSB68 PASTELBLUE 0' 0603	~	~		LED_CL191
V314	4864581	Top	K	5	LED CL191PSB68 PASTELBLUE 0' 0603	~	~		LED_CL191

Item	Product Code	Location Side, Grid ref.			Description and value			Type
V315	4864581	Top	K	7	LED CL191PSB68 PASTELBLUE 0' 0603	~	~	LED_CL191
V318	4864581	Top	M	3	LED CL191PSB68 PASTELBLUE 0' 0603	~	~	LED_CL191
V319	4864581	Top	M	8	LED CL191PSB68 PASTELBLUE 0' 0603	~	~	LED_CL191
V801	4115821	Bottom	C	5	SCHDIX2 HSMS282C 15V <1PF SOT323	~	~	SOT323_H1.1
V802	4210171	Bottom	D	9	TR NE68119 ***RESERVED HDB12***	~	~	SC75
X101	5460061	Bottom	T	6	SM SYSTEM CONNECTOR 14POL	~	~	SYSCON_MQ202_NK_14R3
X103	5409253	Bottom		8	SM BATTERY CONN 3POL SPR 12V 2A	~	~	LYNX_BATT_CONN
X302	5469175	Top	B	7	SM CONN BTB 2X5 F P0.5	~	~	CON_DF23C_10DS
X387	5409219	Bottom	Q	7	SM WIM CONNECTOR 6POL P2.54	~	~	SIM_91485_0001
Z300	4120031	Bottom	0	6	EMI/ESD FILT EMIF10-1K010F1 BGA24	~	~	uBGA24
Z601	4510385	Bottom		4	DIPL+3XSW 880-960/1710-1990MHZ 7X5	880-960/1710-1990MHz	~	ANT_SW_KH
Z602	4511313	Bottom	F	5	SAW FILT 1842.5+-37.5MHZ 2.5X2.0	1842.5MHz	~	FILTER_SAW_SAFSD
Z603	4511367	Bottom		4	SAW FILT 1960+-30MHZ/4DB 2.0X2.5	1960MHZ	~	FILTER_SAW_DCS6I_H1.1
Z604	4511279	Bottom	F	4	SAW FILT 942.5+-17.5MHZ/3.5 2.5X2	942.5MHz	~	FILTER_SAW_SAFSD
Z701	4511311	Bottom	H	6	SAW FILT 897.5+-17.5MHZ/3.5 2.5X2	897.5MHz	~	FILTER_SAW_SAFSD

Component layout diagram Top

f_05a_asmdrw_t.pdf, AUTOSCALE

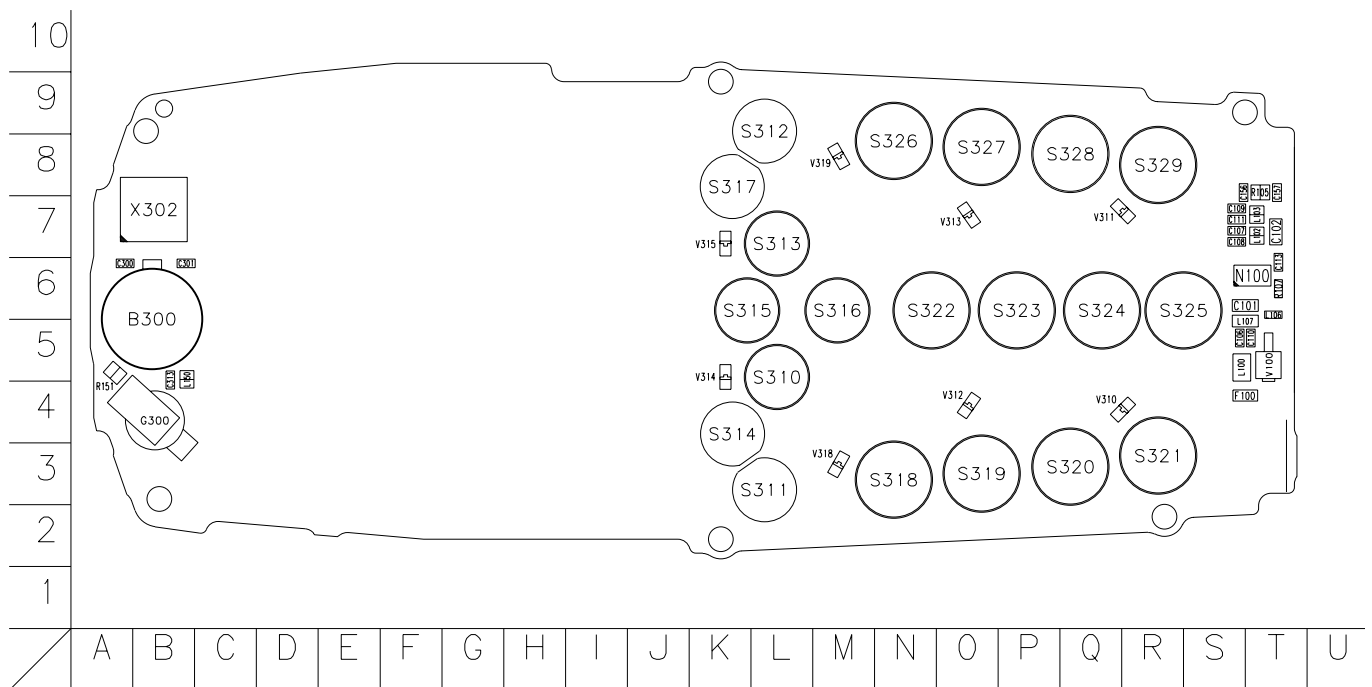

Component layout diagram Bottom

mx4_05ams_asmdrw_b.pdf

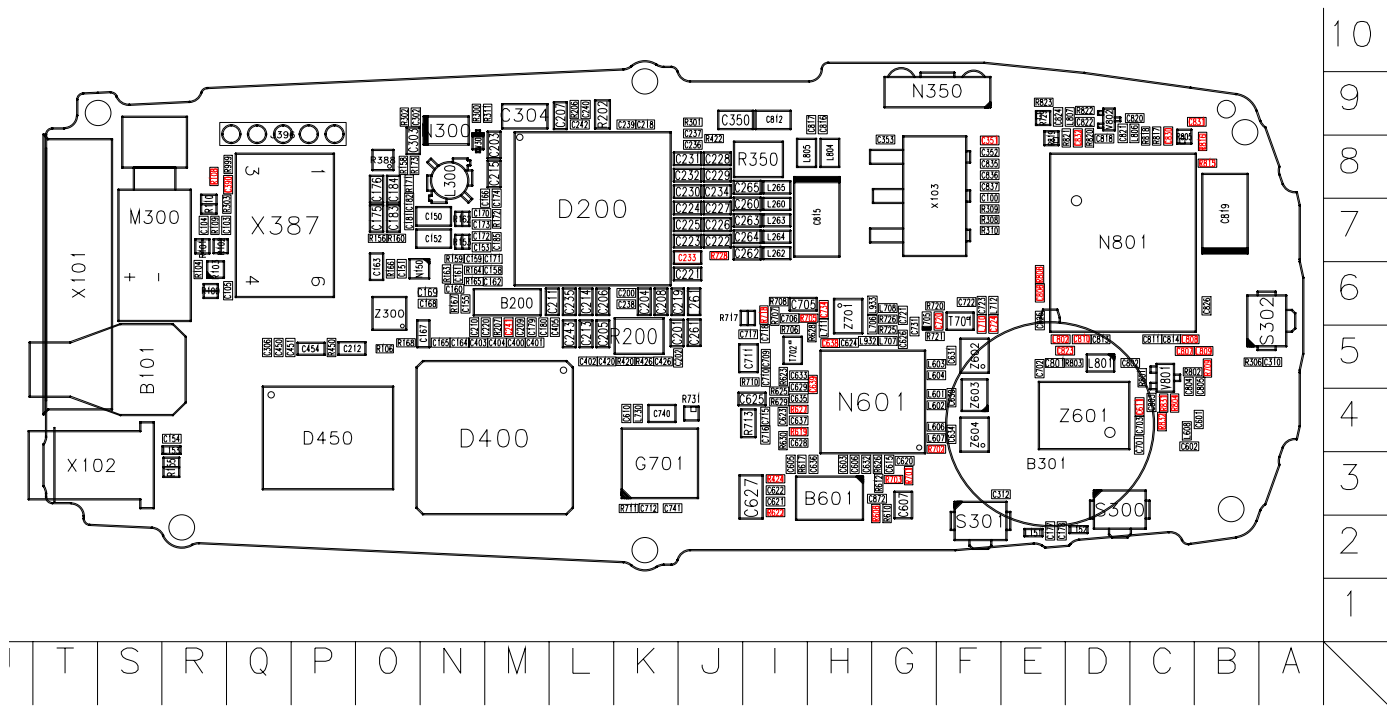

This page has been intentionally left blank.